

INSTRUCTIONS

1- Remove your existing fence

- a. Remove the front rail including any mounting brackets.
- b. If your fence uses a rear rail it will not be used, however, you can leave it in place if it is needed to support an extension table.

2-Join the 2 halves of the fence rail and locate its position on the saw

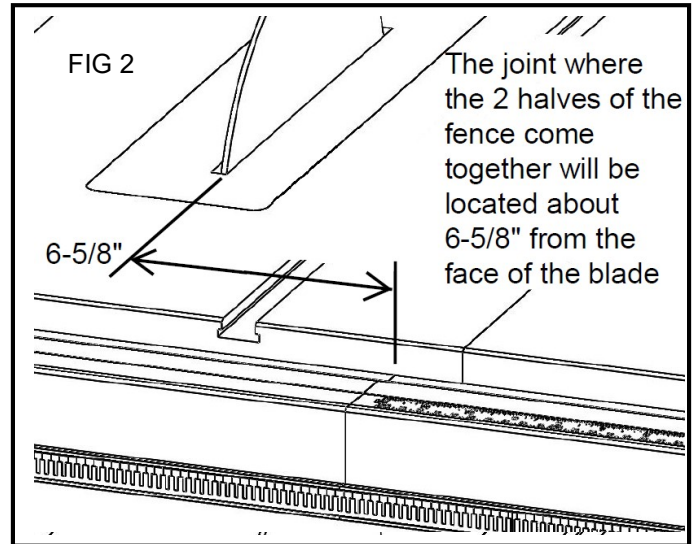
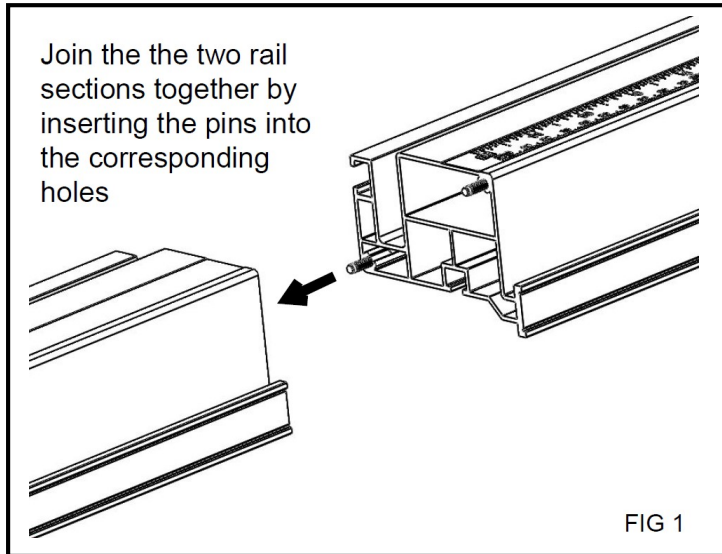

3- Locate mounting holes or drill new ones if needed

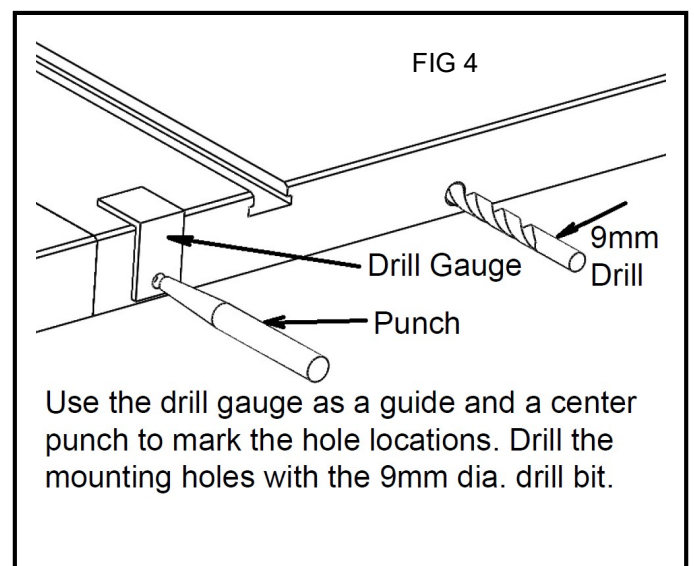
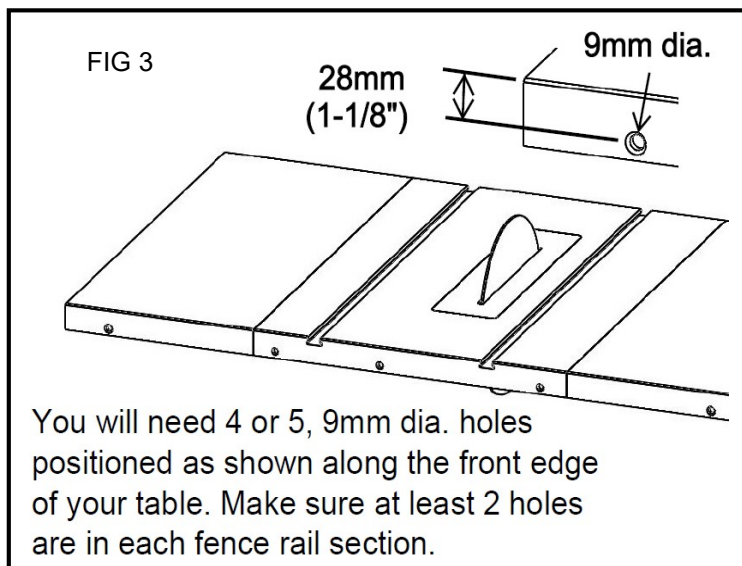

4- Attach the front rail to the saw

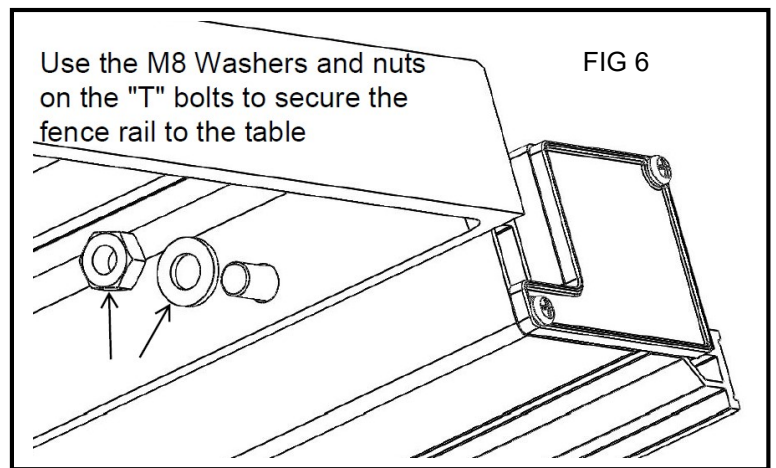
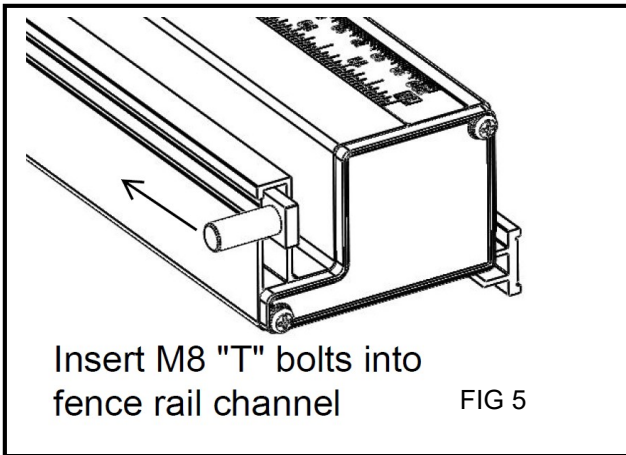

5- Assemble the carriage and fence body

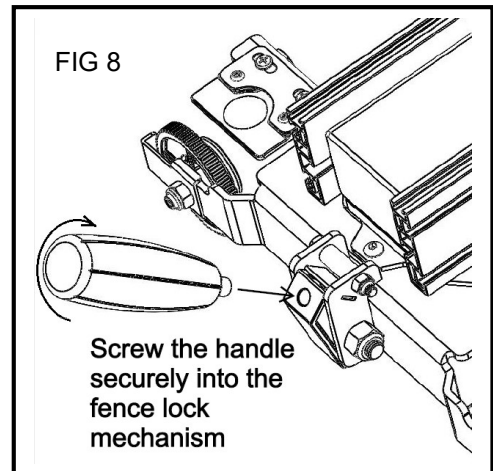
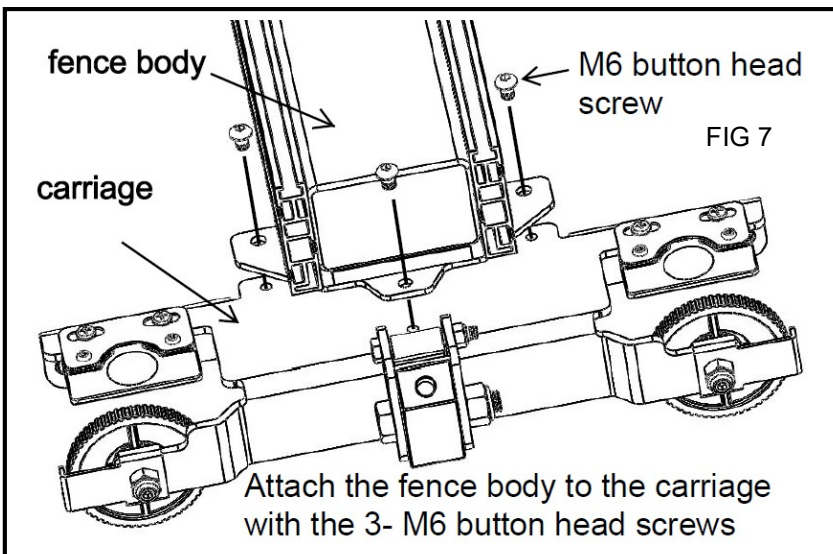

6- Fence Installation and adjustments

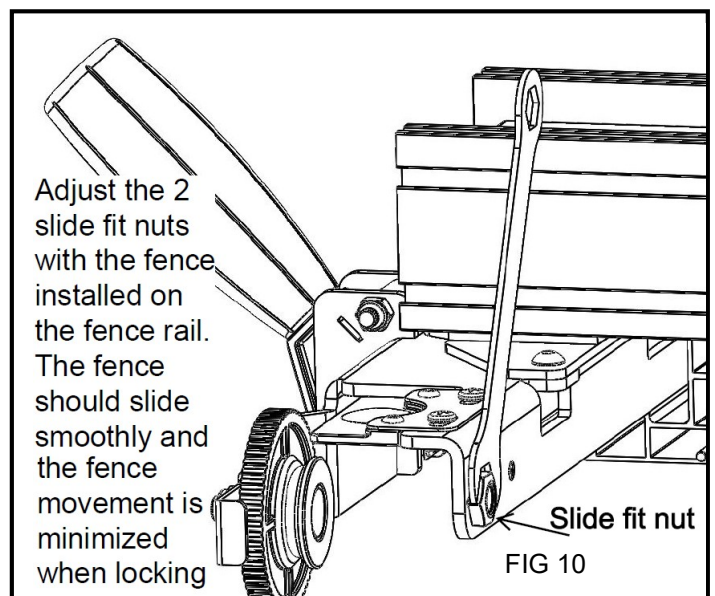
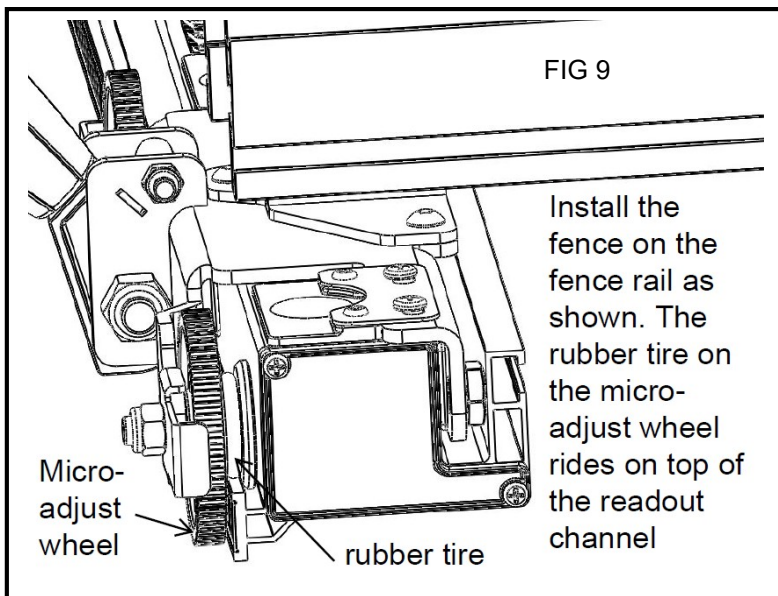

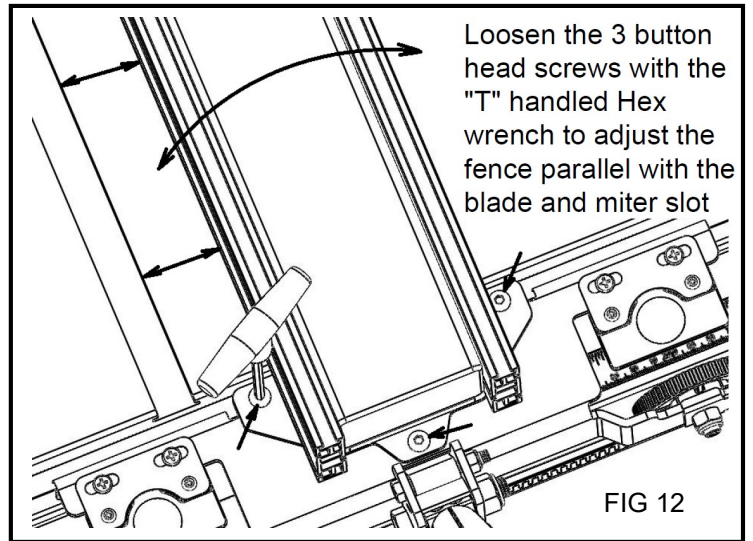
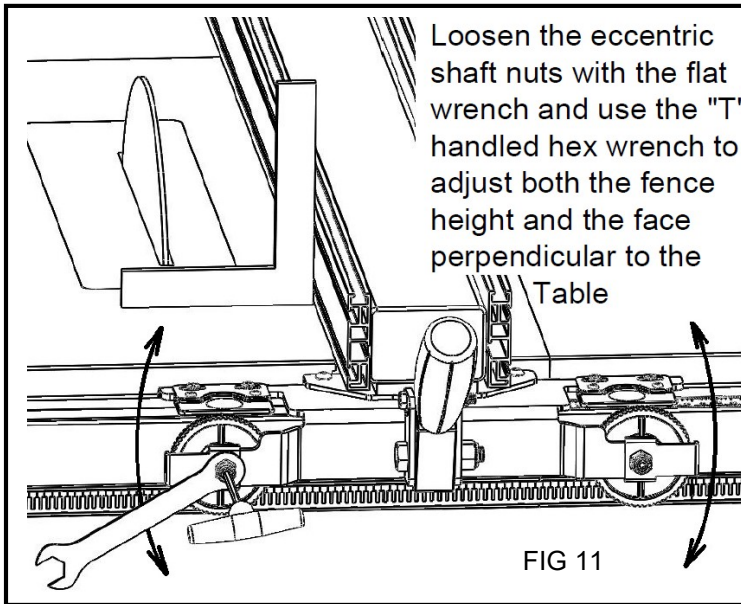

7- Installing the readout and fence operation

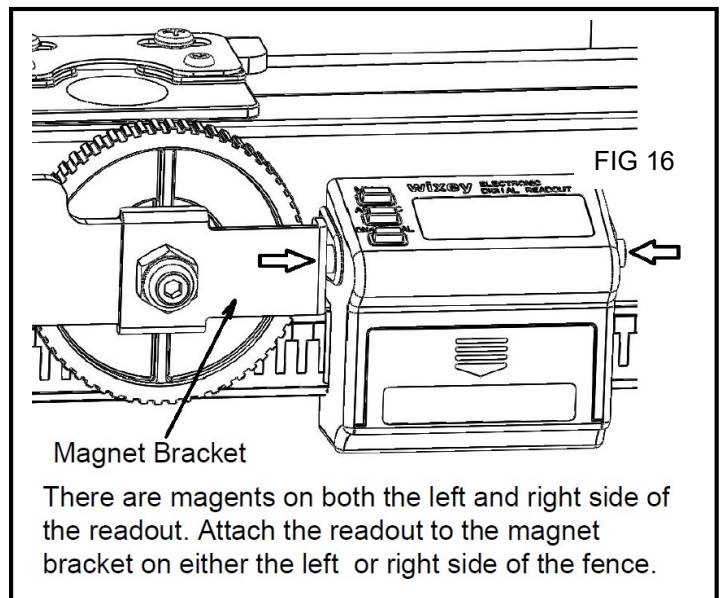
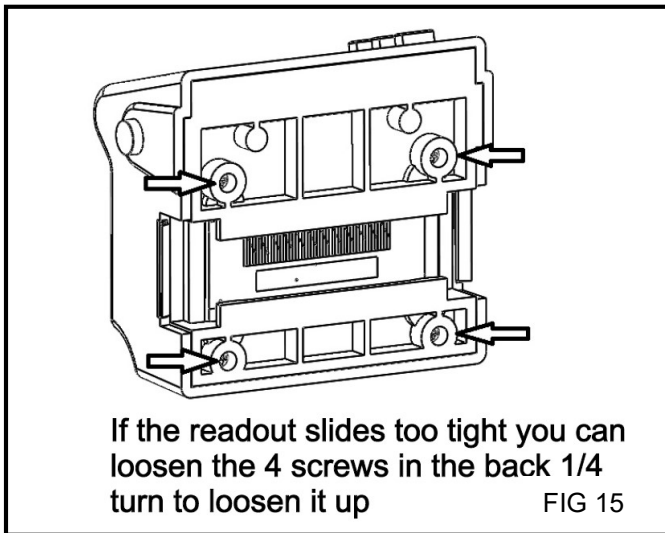
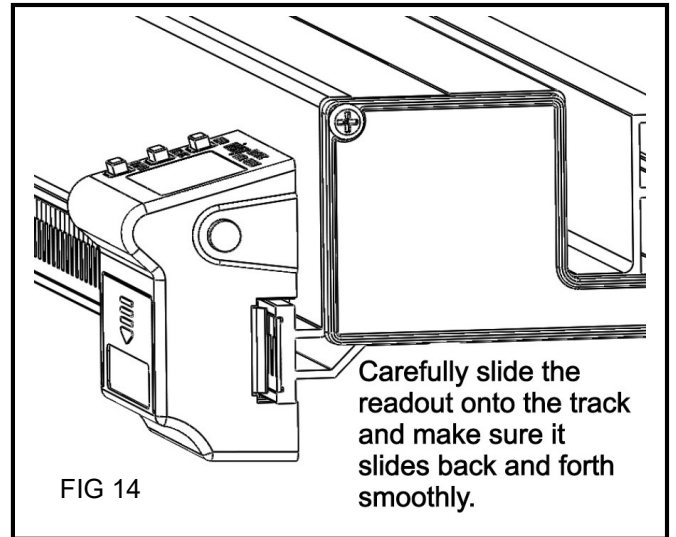
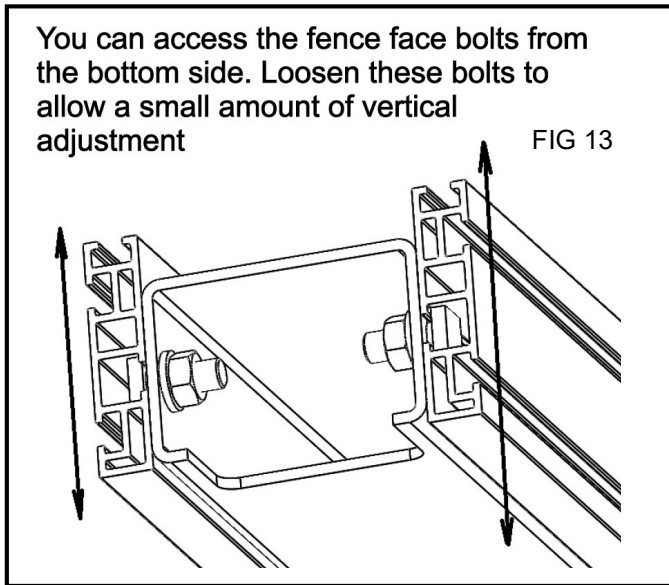

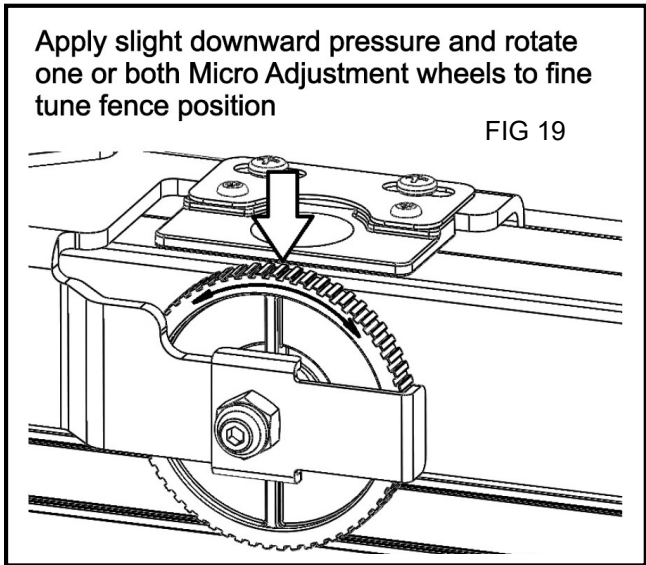
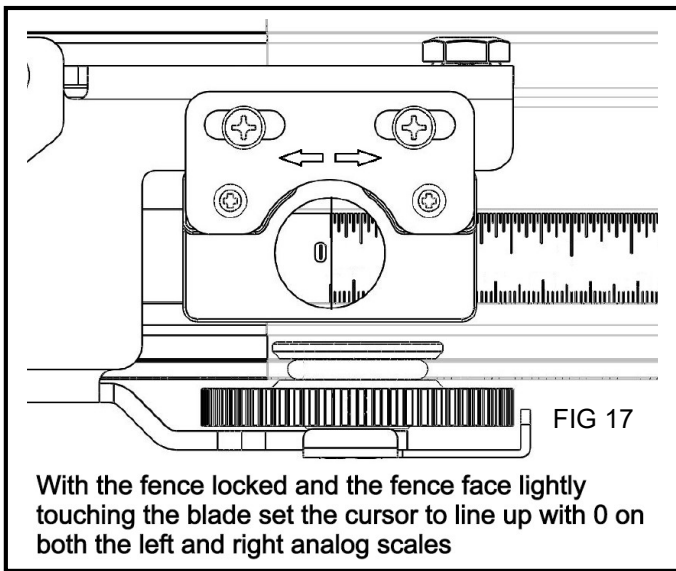

8- Readout operation

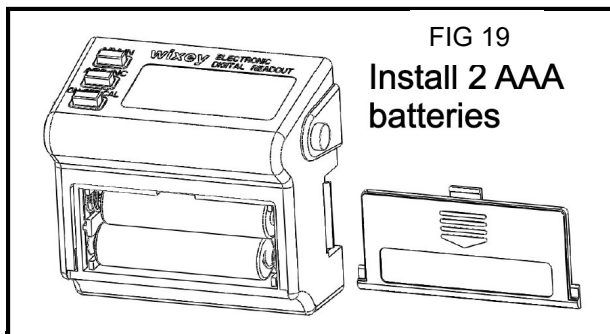

ON/OFF and CALIBRATION FIG 20

- PUSH MOMENTARILY TO TURN OFF AND ON
- HOLD FOR 3-5 SECONDS TO ENTER CALIBRATION MODE. THE "ABS IN" FLASHES
- TO CHANGE THE DISPLAY VALUE FROM 0.000 USE THE + OR - BUTTONS.

- A SHORT PRESS INCREASES ONE DIGIT. HOLDING THE BUTTON COUNTS FAST.
- PRESS THE ON/OFF BUTTON MOMENTARILY TO SET THE CALIBRATION VALUE. THE "ABS IN" WILL STOP FLASHING

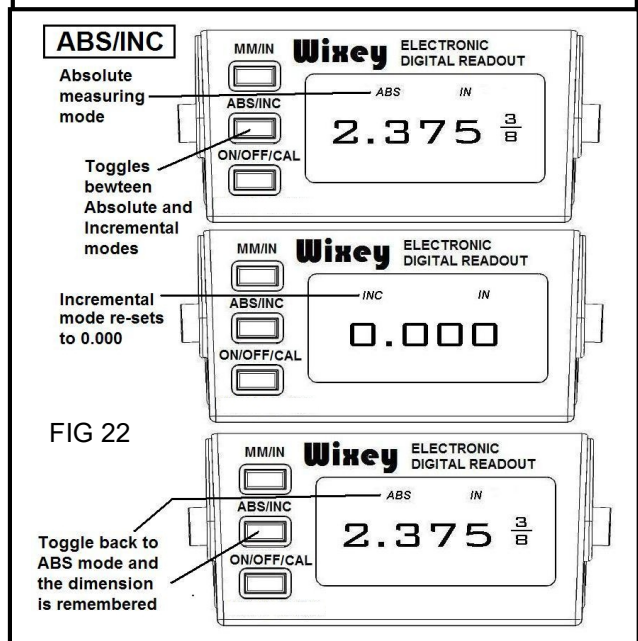
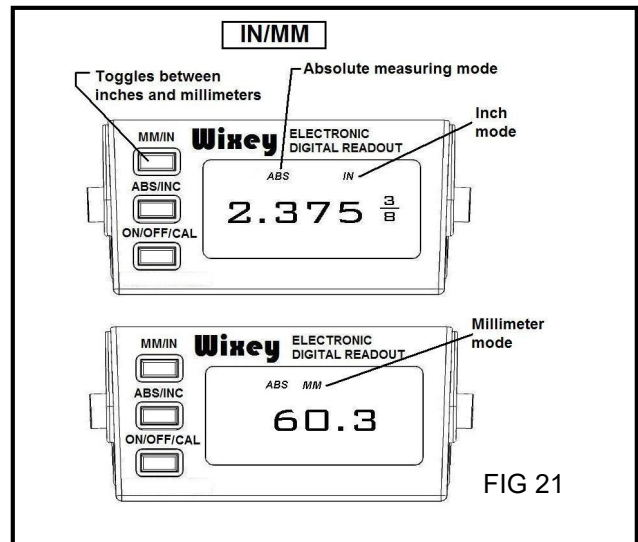

9- Trouble shooting

Readout issues

The Digital Readout may display numbers counting randomly when the unit is turned “ON”, but not on the track with the sensor strip. This is normal and does not mean your Readout is defective.

Unstable constantly scrolling numbers

- Remove batteries, wait 30 seconds, then replace.

Flashing digits, dim, or no display

- Install new batteries.
- Clean batteries and battery contacts with pencil eraser

Frozen display

- Remove the batteries, wait 30 seconds and replace them.

Loses calibration

- Clean the track and sensor strip and blow the dust out of the readout.
- Check for static discharges from a nearby dust collector or other source.

Note: If a static discharge from your finger zaps the readout or a nearby dust collector happens to zap your saw it can cause this error. Make sure the dust collector is properly grounded and the dust port on your saw is grounded to the ground wire inside the dust collector hose.

Accuracy Issues

Small accuracy errors of 1/16” or less

- If you are measuring across the gap, double check the connection with the alignment gauge.
- Check to make sure you are locking the fence both when calibrating the unit and when taking a measurement. The fence surface can move quite a bit depending on your fence when locked vs. un-locked.
- Be sure to just “kiss” the blade with your fence when calibrating. You should be able to move the blade back and forth with your hand (un-plugged and turned off of course) and just feel it gently scraping. It is very easy to deflect your blade and have the measurement be off by up .030 or more.
- **Throw away your tape measure!!!** We are not trying to pass the buck but we have gone down this road many times. The scales on most fences and many tape measures are way off. Many people write to us and say they ended up throwing all their tapes away and buying high quality name brand tapes after they got our system. Use a high-quality steel scale to check the accuracy.

Large accuracy errors of .200" or more

- An error of exactly .200" is a very common error number with these devices or even a multiple of it like .400, .600, 1.200 etc. Usually this only happens when the readout is either moved very quickly (more than 3 feet per second) or if the readout is being affected by static. See "Looses Calibration" above.

Tools included -0

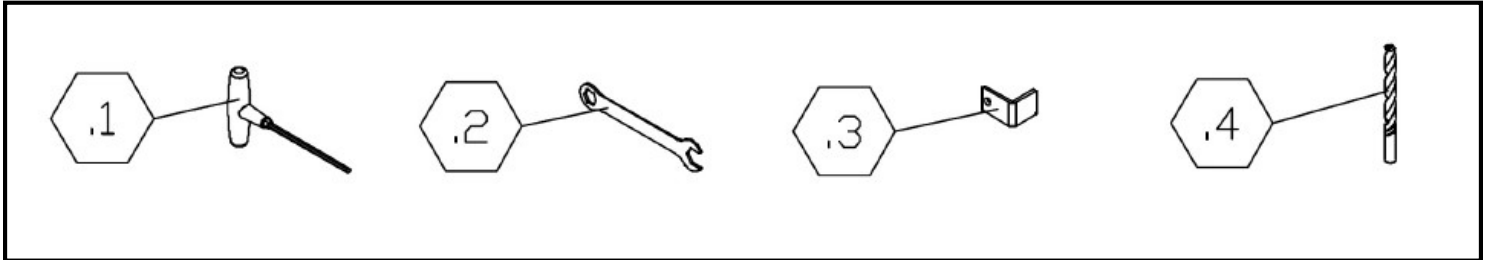

Item	part no.	Description	Spec	qty
0	850955-000	tool kit pack		1
.1	230080-000	T wrench	4mm	1
.2	175056-904	open wrench		1
.3	175057-904	drill gauge		1
.4	042701-002	bit	9mm	1

Fence Assembly-1

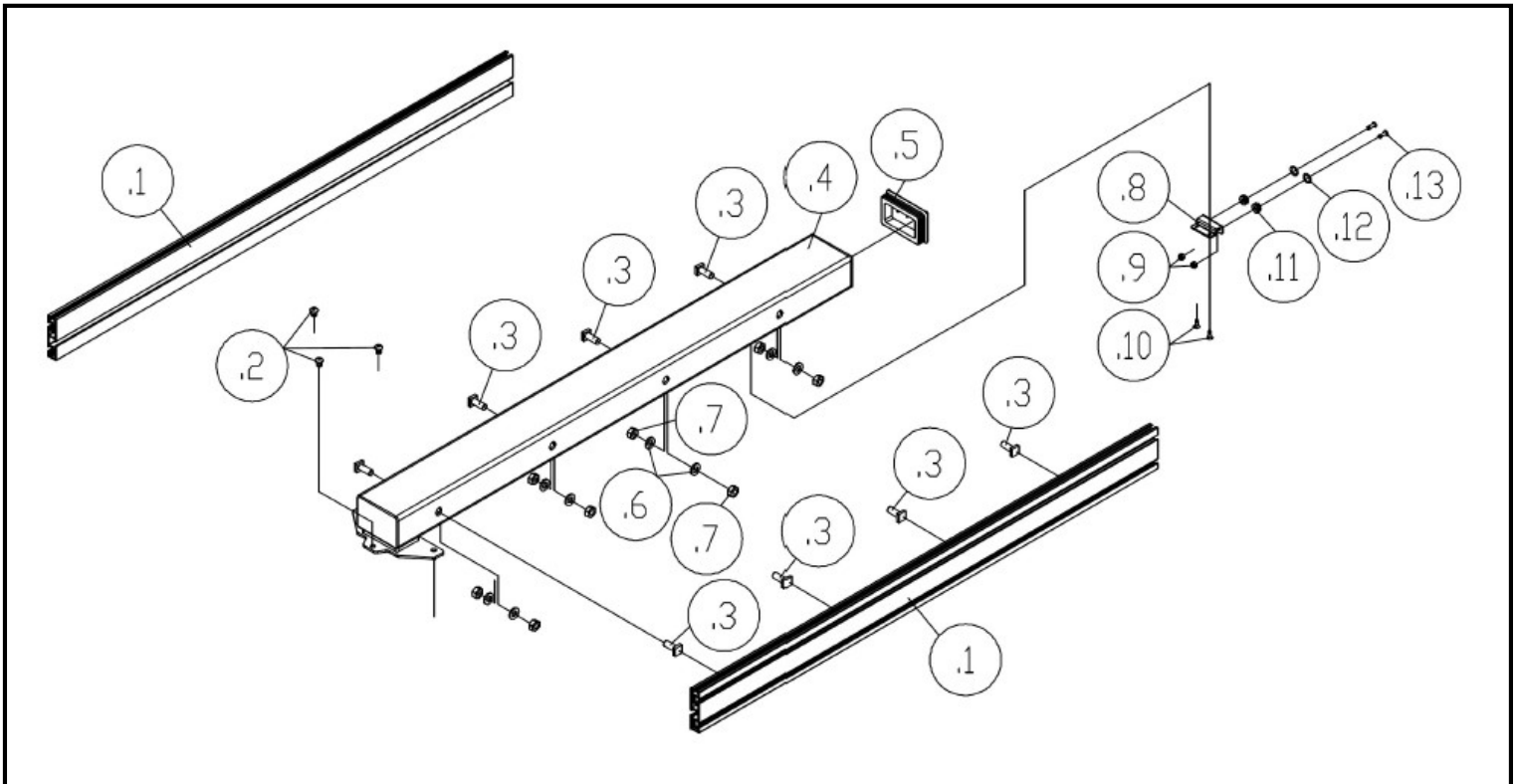

Item	part no.	Description	Spec	qty
1	925056-000	fence assembly		1
.1	310560-909	face plate		2
.2	000801-108	hex socket screw	M6*1.0P*8	3
.3	048701-101	square screw	M8*1.25P*20	8
.4	174965-904	fence body top		1
.5	250624-615	cap		1
.6	006001-049	washer	8.5*16*2t	8
.7	008006-100	hex nut	M8*1.25P(13B*6.5H)	8
.8	174969-904	bracket		1
.9	008301-100	Ny-lock nut	M4*0.7P(7B*5H)	2
.10	000705-104	flat hex screw	M4*0.7P*10	2
.11	361421-901	rear adjust wheel		2
.12	043302-000	O ring	P10	2
.13	000805-103	hex socket screw	M4*0.7P*12	2
.14	008306-100	Ny-lock nut	M8*1.25P(13B*9H)	2
.15	174967-904	bracket		2
.16	925014-000	fence body bottom assembly	#904	1
16.1	174966-000	fence body bottom		1
16.2	290111-901	special screw	M10*1.0P	2
.17	251448-668	adjust wheel		2
.18	043902-000	O ring	4w*22d	2
.19	361420-901	shaft		2
.20	000303-201	Phillips screw	M5*0.8P*6	4
.21	001101-205	Self-tapping screw	M3*1.06P*6	4
.22	174968-905	pointer plate		2
.23	250799-620	pointer		2
.24	250471-621	wear plate		2
.25	006703-100	wavy washer	WW-10	2
.26	251449-668	adjust nut	M10*1.0P	2
.27	000002-308	hex screw	M6*1.0P*45	1
.28	171993-904	bracket		1
.29	008304-100	Ny-lock nut	M6*1.0P(10B*6H)	1
.30	250602-621	wear plate		1
.31	922141-000	cam assembly		1
	130235-903	cam		1
	660002-000	magnet		2
.32	230301-615	handle		1
.33	000004-306	hex screw	M10*1.5P*50	1

.34	008308-100	Ny-lock nut	M10*1.5P(17B*12H)	1
.35	041306-002	plastic bag	190*130*0.15t	1

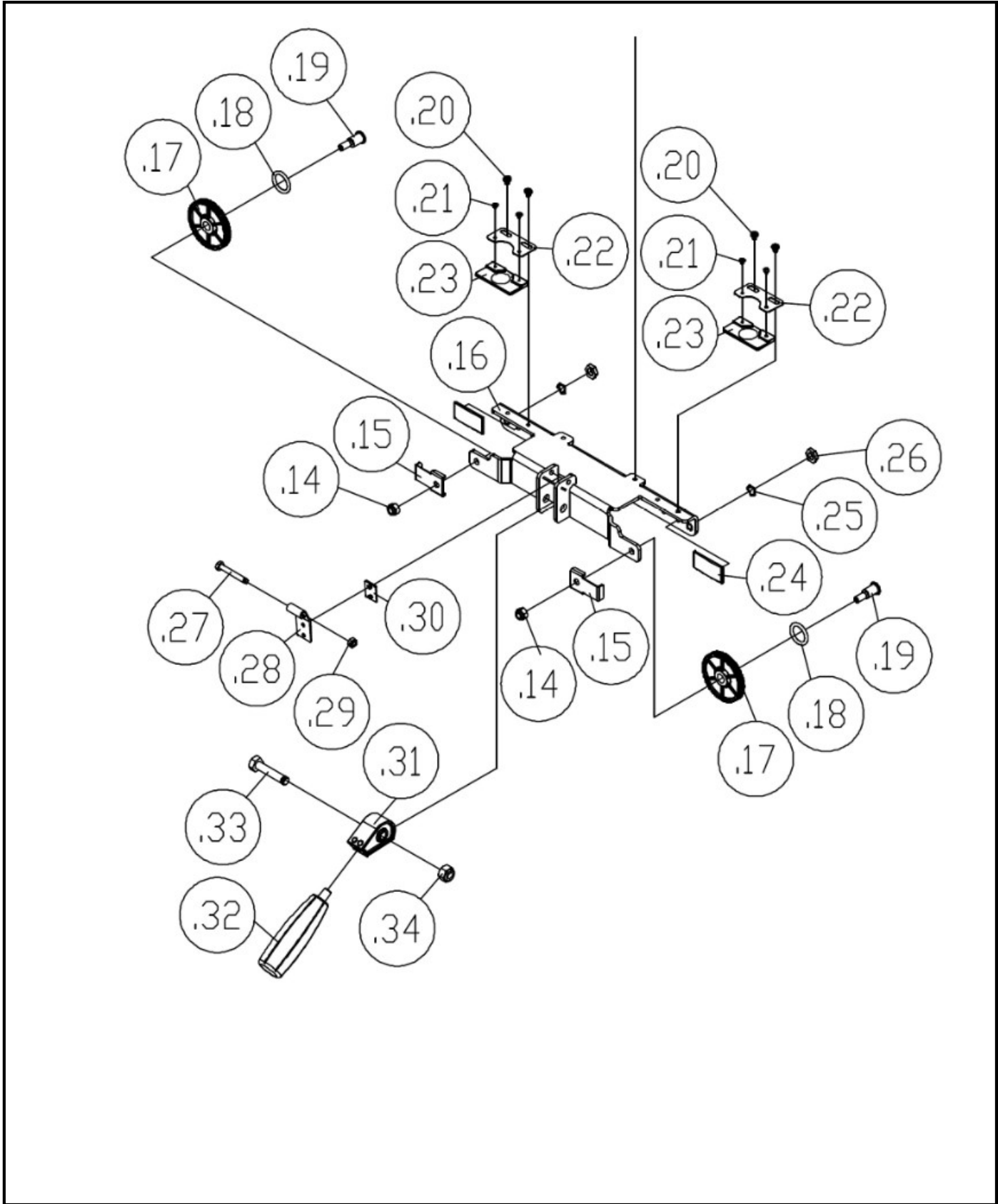

Rails Assembly- 2

2	925057-000	rails assembly		1
2	006001-049	washer	8.5*16*2.0t	5
3	008006-100	hex screw	M8*1.25P(13B*6.5H)	5
4	048701-101	square screw	M8*1.25P*20	5
6	925065-000	front rail assembly	36"	1
6.1	310554-909	front rail	36"	1
6.2	573036-000	right scale	0"~36"	1
6.3	WR7003	sensor strip	Wixey WR7003*800mm	1
6.4	WR7003	sensor strip	Wixey WR7003(800mm/232mm)	1
6.5	250699-615	right cap		1
6.6	001102-604	Self-tapping screw	M4*1.59P*12	2
7	925066-000	left rail assembly	12"	1
7.1	310559-909	left rail		1
7.2	573035-000	left scale	0"~12"	1
7.3	WR7003	sensor strip	Wixey WR7003(800mm/380mm)	1
7.4	250698-615	left cap		1
7.5	001102-604	Self-tapping screw	M4*1.59P*12	2
7.6	360249-905	connection pin		2

Digital Readout-3

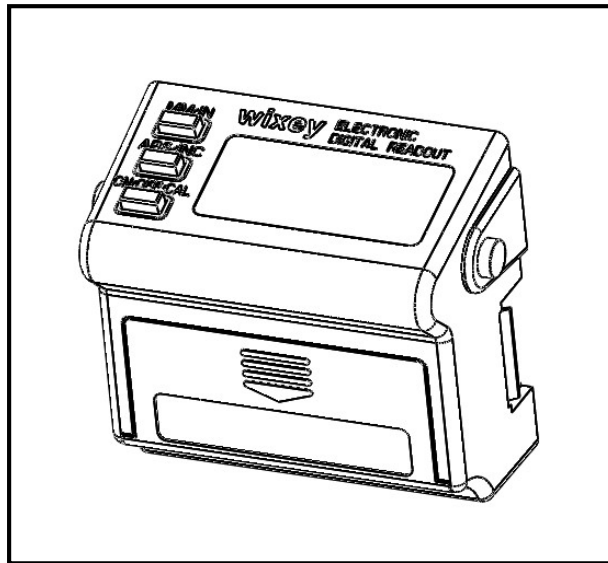

Item	part no.	Description	Spec	qty
3	WR7001	DRO assembly	Wixey WR7001	1

For questions, comments, and application examples go to: www.wixey.com